

**thermomix**

Cutter

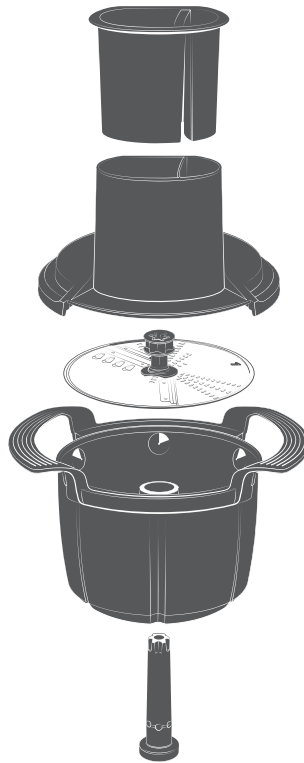

# User manual

EN • V1.0 • 27033 03/22





### Digital Welcome Booklet

Read our digital welcome booklet for more information on the Thermomix® Cutter and for inspiration, recipes and tips.

### Your Thermomix® Advisor:

**Telephone:**

**Fax:**

**Mobile:**

**E-mail:**

### Copyright

The copyright for text, design, photography and illustrations lies with Vorwerk International & Co. KmG, Switzerland. All rights reserved. This publication may not – in part or in whole – be reproduced, stored in a retrieval system, transmitted or distributed in any form or by any means, electronic, mechanical, photocopying, recording or otherwise, without the express prior consent of Vorwerk International & Co. KmG.

# Table of Contents

<b>1</b>	<b>Before you start.....</b>	<b>4</b>
1.1	Product description .....	4
1.2	Storing of product documentation .....	4
<b>2</b>	<b>Product overview .....</b>	<b>5</b>
<b>3</b>	<b>Intended use.....</b>	<b>5</b>
<b>4</b>	<b>For your safety.....</b>	<b>6</b>
4.1	Hazards and safety instructions.....	7
4.2	Classification of safety warning messages .....	8
4.3	Obligations of the user.....	9
<b>5</b>	<b>First use .....</b>	<b>9</b>
<b>6</b>	<b>Operation .....</b>	<b>9</b>
6.1	Assembling the accessory .....	9
6.2	Selecting the cutting side and type of cut .....	11
6.3	Grating and cutting ingredients .....	12
6.4	Removing the cutting disc.....	14
<b>7</b>	<b>Cleaning.....</b>	<b>15</b>
<b>8</b>	<b>Customer Care UK &amp; Ireland .....</b>	<b>15</b>
<b>9</b>	<b>Warranty/Liability for Material Defects.....</b>	<b>16</b>
<b>10</b>	<b>Manufacturer.....</b>	<b>16</b>
<b>11</b>	<b>Disposal .....</b>	<b>16</b>

# 1 Before you start

As a Thermomix® user, you are already familiar with the Thermomix® TM6 or TM5 and their accessories.

This manual will instruct you with regard to the use of the Thermomix® Cutter for your Thermomix® TM6 or TM5.

1. Read the instruction manual carefully before using the Thermomix® Cutter for the first time.
2. You must also read and observe the instruction manual for the Thermomix® TM6 or TM5, which is supplied with the appliance. If you do not have the instruction manual to hand, all manuals are available online at <https://thermomix.vorwerk.com>.

## Digital Welcome Booklet



Read our digital welcome booklet for more information on the Thermomix® Cutter and for inspiration, recipes and tips.

## 1.1 Product description

The Thermomix® Cutter is an accessory for your Thermomix® TM6 or Thermomix® TM5.

In combination with the Thermomix® Cutter, your Thermomix® will precisely and evenly grate and slice ingredients, such as fruit, vegetables and cheese, in seconds.

## 1.2 Storing of product documentation

Retain the instruction manual for future reference. It is an important part of the product and must be kept with it if you pass it on to someone else.

## 2 Product overview

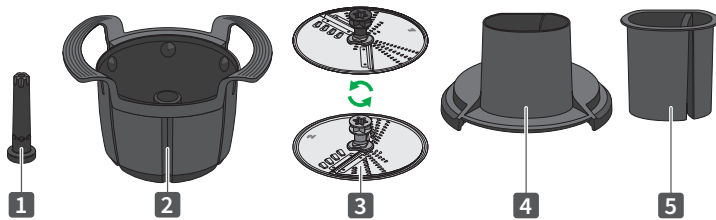

1 Drive shaft	4 Cutter lid
2 Cutter basket	5 Pusher
3 Cutting disc	

**Note** For full details on how to use the Thermomix® and the mixing bowl, see the instruction manual for your Thermomix® TM6 or TM5.

If you do not have the instruction manual to hand, all manuals are available online at <https://thermomix.vorwerk.com>.

## 3 Intended use

Use the device and accessories only for their intended purpose in order to prevent risks to you and other people and to prevent damage to the device or to other property and equipment.

**Operating conditions** The Thermomix® Cutter is an accessory intended for the preparation of food at home or in similar environments.

**Compatibility** The Thermomix® Cutter can be used with the Thermomix® TM6 or TM5.  
The Thermomix® Cutter must **not** be used with the Thermomix Friend®.

**Intended use** The Thermomix® Cutter is placed in the mixing bowl and may be used in a clockwise or reverse rotation with the heating function switched off to chop food. It must **only be used on speed setting 4**.

**Users** This accessory is exclusively intended for use by adults. It must not be used by children even when supervised by an adult.

Keep children away from appliances that are in use.

Close supervision is necessary when this accessory is used near children.

Children must not play with this accessory.

Appliances may be used by persons with reduced physical, sensory or mental capabilities, or lack of experience and/or knowledge if they are supervised or have been instructed on the safe use of the appliance and understand the resulting hazards.

**Improper use** The Thermomix® Cutter must not be used or cleaned with alcohol.

This appliance may only be used for its intended purpose. No other use is permitted. The manufacturer bears no responsibility for damages resulting from improper use. If the appliance is subject to technical modifications, the warranty and liability for material defects shall be rendered invalid. If technical modifications are made to the product, the manufacturer's obligation to compensate for product liability and/or the dealer's obligation to compensate for material defects shall no longer apply.

When working with the appliance, please follow the instructions in all the accompanying documentation as well as on the display. The manufacturer accepts no liability for damages resulting from improper use.

**Safety regulations** The device complies with the safety regulations of the country in which it has been sold by an authorised Vorwerk organisation. If the device is used in another country, compliance with the local safety standards cannot be guaranteed. Vorwerk therefore assumes no liability for any resulting safety risks for the user.

## 4 For your safety

Safety is an essential part of every Vorwerk product.

However, product safety can only be ensured if the information in this chapter and the warning notices in the following chapters are observed.

**Note** The Thermomix® Cutter is designed to be used exclusively with the Thermomix® TM6 and Thermomix® TM5. It is not compatible with older predecessor models or with the Thermomix Friend® and must not be used with appliances from other manufacturers. Observe the safety instructions in all applicable documents and the instructions on the display.

## 4.1 Hazards and safety instructions



### WARNING

**Risk of injury from damaged accessories.**

**If accessories get caught in the mixing knife or excessive force is applied during use, small splinters and sharp edges could cause injury, especially if the splinters are swallowed with the prepared food.**

- Only use Thermomix® accessories as described in the operating instructions and on the display of the base unit.
- Check accessories for damage after use.
- If any accessories are damaged by the mixing knife during food preparation, discard the food and contact Customer Care for replacement accessories.

**Risk of injury from using incorrect accessories.**

**The use of attachments, accessories or items not recommended or sold by Vorwerk or an organisation authorised by Vorwerk, or the use of defective or incompatible accessory parts may cause fire, electric shock or injury.**

- Only use the recommended original Vorwerk accessories.
- Only use this accessory with the Thermomix® TM6 or TM5 and never with any older predecessor models.
- Do not modify this accessory.
- Do not use this accessory if it is damaged.
- Inspect the cutting disc for distortions, especially if it has been dropped. If the cutting disc is distorted or damaged, stop using it and replace it immediately.

**Risk of injury as a result of the appliance falling over.**

**The appliance may move while in operation. It could fall over and injure you.**

- Place the appliance on a clean, solid and even surface.
- Ensure that there is sufficient distance between the appliance and the edge of the work surface.
- Never leave the appliance unattended while it is running.

**Risk of scalding.**

**This accessory is not designed for preparing hot food. Steam or hot liquid could suddenly escape and scald you.**

- Do not use the heat function when using this accessory.
- Do not fill the mixing bowl with water, especially hot water, when using this accessory.



### CAUTION

<b>Risk of cuts.</b>	<p><b>The blades on the cutting disc are sharp and can injure you.</b></p> <ul style="list-style-type: none"> <li>• Handle the cutting disc with caution.</li> <li>• Never take hold of the cutting disc by the blades and only by the centre section.</li> <li>• Never reach into the fill compartment when the accessory is assembled.</li> </ul>
<b>Risk of pinching your fingers.</b>	<p><b>You can catch your fingers in the locking arms on the base unit or under the mixing bowl lid.</b></p> <ul style="list-style-type: none"> <li>• Avoid contact with moving parts.</li> <li>• Keep hair and clothing away from moving parts.</li> <li>• Do <b>not</b> touch the locking arms or the mixing bowl lid while the locking mechanism is opening or closing.</li> </ul>
<b>Risk of injury from improper use.</b>	<p><b>If this accessory is used with other devices, parts could come loose and injure you.</b></p> <ul style="list-style-type: none"> <li>• Only use this accessory with the Thermomix® TM6 or TM5.</li> <li>• Never use this accessory with the Thermomix Friend®.</li> </ul>
<b>Risk of burns from hot metal surfaces.</b>	<p><b>The metal pin on the lid can become extremely hot with continuous use under load (continuous use of the cutting function for more than 3 minutes).</b></p> <ul style="list-style-type: none"> <li>• Allow the lid (minus cutting disc) to cool down for 15 minutes, or cool the metal pin on the lid with water before touching it.</li> </ul>



## NOTICE

<b>Risk of damage from improper use.</b>	<p><b>This accessory could get damaged if used incorrectly.</b></p> <ul style="list-style-type: none"> <li>• Only use this accessory on speed setting 4.</li> <li>• Only use this accessory when fully assembled.</li> <li>• Do not process frozen food.</li> <li>• Only use the original Thermomix® pusher.</li> <li>• Only press lightly on the pusher when pressing food down towards the cutting disc. Do not apply force when using the pusher.</li> </ul>
<b>Risk of damage as a result of incorrect cleaning.</b>	<p><b>Objects can become distorted in the dishwasher as a result of increased heat exposure and pressure from items above.</b></p> <ul style="list-style-type: none"> <li>• Space all the components out on the top rack of the dishwasher.</li> </ul>

## 4.2 Classification of safety warning messages

The safety warning messages in this manual are highlighted by safety symbols and signal words. The symbol and signal word indicate the severity of the potential hazard.



### Classification of safety warning messages



The safety warning messages that precede each action are shown as follows:

WARNING	
	<b>Type and source of hazard</b>
	<b>Explanation of type and source of hazard/consequences</b>
	<ul style="list-style-type: none"><li>Measures to prevent hazard</li></ul>

### Meaning of signal words

WARNING	Risk of death or serious injury if hazard is not avoided.
CAUTION	Risk of minor injury if hazard is not avoided.
NOTE	Material damage if hazard is not avoided.

### Meaning of safety symbols

	Safety warning message indicating the severity of the potential hazard
	Reference to material damage

## 4.3 Obligations of the user

To ensure that your appliance and Vorwerk accessory operate correctly, please follow the guidelines below:

1. Please read the instruction manual and all accompanying documents carefully.
2. Keep the manual near the appliance.
3. Ensure that any damage to the appliance is repaired by the manufacturer without delay.

## 5 First use

Clean the Thermomix® Cutter before first use, see [Cleaning](#) [▶ page 15].

## 6 Operation

### 6.1 Assembling the accessory

**Important:** Only place the Thermomix® Cutter into an empty mixing bowl. Make sure that there is no food or liquid in the mixing bowl, especially on the mixing knife, before placing the drive shaft onto the mixing knife. It is not necessary to thoroughly clean the mixing bowl before using the Thermomix® Cutter.

To insert the Thermomix® Cutter into the mixing bowl, proceed as follows:

- Make sure that the mixing bowl is correctly positioned and fully inserted in the Thermomix® TM6 or TM5.

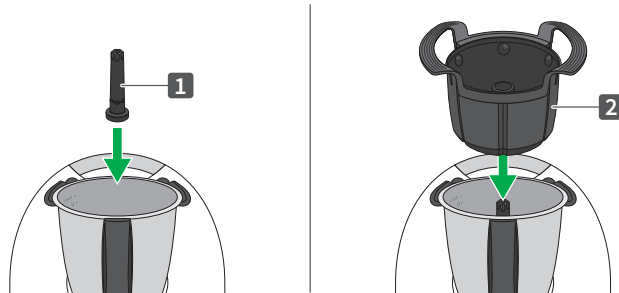

1. Place the drive shaft (1) onto the mixing knife in the mixing bowl.
2. Place the cutter basket (2) onto the drive shaft.

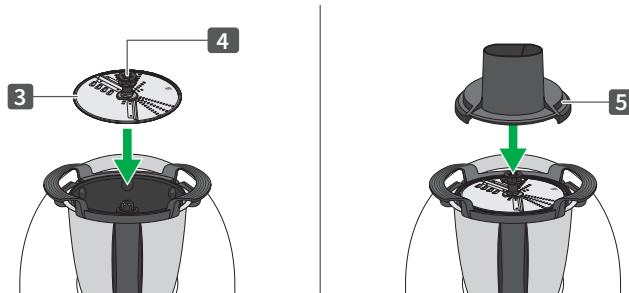

3. Hold the cutting disc (3) by the centre section (4) and place it onto the drive shaft with the side you want to use facing upwards, see [Selecting the cutting side and type of cut](#) [▶ page 11].
  4. Put the cutter lid (5) on the cutter basket.
- ⇒ *The Thermomix® Cutter is now ready for use.*

## 6.2 Selecting the cutting side and type of cut

### CAUTION









#### Risk of cuts.



The blades on the cutting disc are sharp and can injure you.

- Handle the cutting disc with caution.
- Never take hold of the cutting disc by the blades and only by the centre section.
- Never reach into the fill compartment when the accessory is assembled.

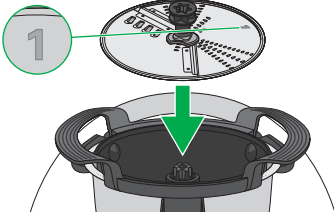
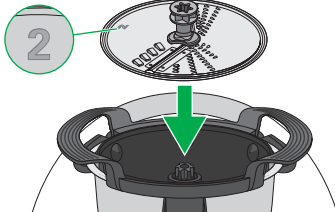
The Thermomix® cutting disc has two different cutting sides with which you can grate or cut ingredients into strips or slices.

Type of cut	Slices 		Strips 	
Thickness	approx. 4 mm	approx. 1 mm	approx. 3-4 mm	approx. 1 mm
Rotation direction				
Side of cutting disc	Side 1 (dark grey) facing upwards		Side 2 (light grey) facing upwards	
				

The thickness is set using the rotation direction.

- Select reverse rotation (anti-clockwise)  if you want a thinner cut.
- For thicker slices or strips, stay in clockwise rotation .

## 6.3 Grating and cutting ingredients

**Tip** You can find an overview of the best types of cut for different ingredients in the welcome booklet.

### NOTICE







#### Risk of damage from improper use.

#### This accessory could get damaged if used incorrectly.

- Only use this accessory on speed setting 4.
- Only use this accessory when fully assembled.
- Do not process frozen food.
- Only use the original Thermomix® pusher.
- Only press lightly on the pusher when pressing food down towards the cutting disc. Do not apply force when using the pusher.

- Make sure that the Thermomix® Cutter is inserted correctly, see [Assembling the accessory](#) [▶ page 9].

**TM6 function** • Select the desired function (cutting  or grating ) from the TM6 menu and follow the instructions on the display.

**TM5 (manually)** • Select the rotation direction depending on how you want to cut or grate your ingredients.  
- Select reverse rotation (anti-clockwise)  if you want a thinner cut.  
- For thicker slices or strips, stay in clockwise rotation .

**Speed setting 4 max. 3 minutes** • Turn the selector to start the Thermomix® before you fill the appropriate opening with ingredients. When selecting the speed manually, gradually increase the speed up to setting 4.  
**Note:** Do not operate the device for **more than 3 minutes** when solely using the cutting function.

⇒ *You can now add the ingredients, see next step.*

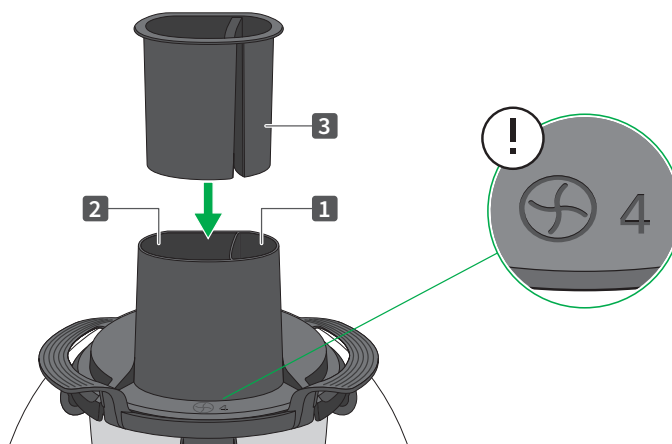

- Filling with ingredients**
1. Loosely tip the ingredients into the appropriate opening, a little at a time. Choose the small opening (1) if you want to cut or grate ingredients such as carrots, strawberries or small mushrooms into evenly sized slices. Put larger ingredients, such as potatoes, into the large opening (2). Using cutting side 2, you will get short strips from opening (1) and longer strips when placing ingredients horizontally in opening (2). If, for example, you put longer pieces of carrot lengthways into opening (2), you will get strips the length of the carrot pieces.
  2. If an ingredient is too large for the opening, cut it in half or into several pieces as required (e.g. cut big apples into 3 wedges, peeled pineapple into 4 or more wedges, etc.).
  3. Lightly press the ingredients down using the pusher (3).

**Holding function** When you press the pusher down fully, it clicks into this position (holding function). Always allow the pusher to click into position at the end of the cutting or grating process. This will ensure that it does not fall out when you remove and invert the cutter lid.

**Note about the pusher** You do not need to use force to press down the ingredients. Placing your hand on the pusher and applying minimal pressure is sufficient.

If you find that you are unable to press the pusher down, check whether the opening is too full or food has become stuck.

**Clearing a jammed disc** If the cutting disc becomes stuck, lift up the pusher and press it down again onto the food using minimal pressure.

If the jam does not clear:

1. Stop the cutting/grating process and carefully remove the blockage using the spatula.
2. Never reach into the blades with your hands!

**Removing ingredients** When you remove the cutter lid from the cutter basket, the cutting disc will remain inside the cutter lid. This means that you can take the sliced ingredients straight out and continue preparing or cooking them.

If food has become stuck on the underside of the cutter lid around the edge of the fill compartment, you can easily remove it using the spatula.

## 6.4 Removing the cutting disc

### CAUTION



#### Risk of burns from hot metal surfaces.

The metal pin on the lid can become extremely hot with continuous use under load (continuous use of the cutting function for more than 3 minutes).

- Allow the lid (minus cutting disc) to cool down for 15 minutes, or cool the metal pin on the lid with water before touching it.

If you want to remove or invert the cutting disc, proceed as follows:

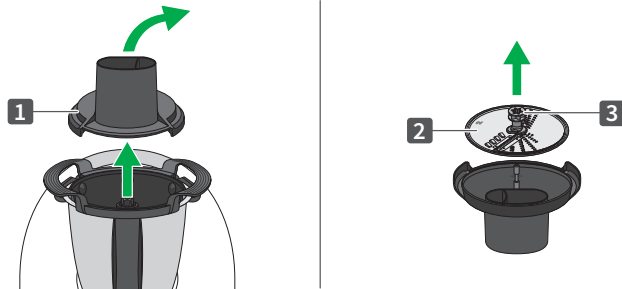

1. Take the cutter lid (1) off the cutter basket and turn it over. The cutting disc will remain inside the cutter lid.
2. Holding the centre section (3), pull the cutting disc (2) away from the cutter lid.

## 7 Cleaning

All components can be washed in a dishwasher.

However, we would recommend cleaning the cutting disc under running water with a washing-up brush. This will help to keep the high-quality blades sharp for longer.

### NOTICE



#### **Risk of damage as a result of incorrect cleaning.**

**Objects can become distorted in the dishwasher as a result of increased heat exposure and pressure from items above.**

- Space all the components out on the top rack of the dishwasher.
- Allow all components to dry thoroughly after cleaning.

## 8 Customer Care UK & Ireland

### Vorwerk Thermomix® Customer Care

Monday to Friday 8:00 to 17:30

Telephone: + 44 330 660 0834

Email: [info@vorwerk.co.uk](mailto:info@vorwerk.co.uk)

[www.thermomix.vorwerk.co.uk](http://www.thermomix.vorwerk.co.uk)

### Vorwerk Thermomix® Service Centre

Monday to Friday 8:00 to 17:00

Telephone: + 44 330 660 0834

Email: [support@vorwerk.co.uk](mailto:support@vorwerk.co.uk)

### Vorwerk Thermomix® UK & Ireland

Ashurst Manor, Church Lane, Ascot, Berkshire, SL5 7DD

For details of your local customer service centre please contact your Thermomix® Advisor, the sales company in your country, or refer to <https://thermomix.vorwerk.com>

This instruction manual is available in other languages at <https://thermomix.vorwerk.com>

## 9 Warranty/Liability for Material Defects

The Thermomix® and its accessories may only be repaired by Vorwerk Customer Service or an authorised Vorwerk repair service.

Only use original parts supplied with the Thermomix® or original spare parts from Vorwerk Thermomix®. Never use the Thermomix® in combination with parts or equipment not provided by Vorwerk Thermomix® for the Thermomix®. Otherwise your warranty and the liability for material defects shall be rendered void.

## 10 Manufacturer

Vorwerk Elektrowerke GmbH & Co. KG

Mühlenweg 17-37

42270 Wuppertal

Germany

## 11 Disposal

This original Vorwerk accessory is largely made from recyclable materials. You can dispose of this accessory at a collection point.

It must not be disposed of in household waste.

1. Ensure that this accessory is disposed of properly.
2. Please observe the applicable national regulations regarding disposal.









**thermomix**

Cutter

